

1
NOV 14 1915
DEC 17 1915

4-683.

Mineral Survey No. 3246 A²B

Lot No.

ARIZONA

Land District.

FIELD NOTES

OF THE SURVEY OF THE MINING CLAIM OF

JOSEPH DOUGHERTY and H.C. DREIS

KNOWN AS THE

NEW YORK, INDIANA, IOWA, IDAHO, OHIO GOOD LUCK LODES
INDIANA, OAK TREE Mill-sites.

THUMB BUTTE

Mining District,

YAVAPAI

County, ARIZONA

Sections 14- 15, Township 14 N., Range 3 W.

Surveyed under instructions dated October 6, 1915,

by J. WILLIAM WAARA
U. S. ~~Deputy~~ Mineral Surveyor

Claim located see location notices, 1

Survey commenced October 11, 1915, 1

Survey completed October 16, 1915, 1

o 6-160

Address

J.E. Russell Atty.

Prescott Arizona.

MINERAL SURVEY NO. 3246A&B

OHIO

Beginning at Cor. No.1, identical with corner No.1 of the Iowa Lode, Cor.No.1 Indiana Lode and Cor. No.1 New York Lode of this survey, a granite stone 6 x 8 x 27 inches long set fifteen inches in the ground with substantial mounds of stone alongside; chiseled O-1,I-1,I-1-3246A, N Y-1, on sides facing the respective lodes, with cross on top for exact corner point, from which point,

A granite rock in place 3 x 3 x 2 feet exposed and chiseled BxR,I-1-3246A, brs. S.23°-06'E. 79.5 feet.

A quartz rock in place 8 x 4 x 3 feet exposed and chiseled BxR O-1-3246A, brs. N.75°-04'W. 40.7 feet.

U.S.M.M.No. 3246 Brs. S.50°-58'E. 353.8 feet.

Thence S.54°-55'W.

359.8 SOUTH CENTER END, a mound of stone.

709.0 Cross road, brs. southeast to northwest.

719.6 TO COR. NO.2, on line 4-1 New York Lode of this survey, at N.54°-55'E. 780.4 feet from Cor. No.4, a granite stone 6 x 12 x 20 inches long set twelve inches in the ground with a substantial mound of stone alongside; chiseled O-2-3246A with cross on top for exact corner point, from which point,

A juniper tree 36 inches in diameter, and scribed BxT,O-2-3246A, brs. S.19°-56'E. 78.6 feet.

A juniper tree 44 inches in diameter and scribed BxT,O-2-3246A, brs. S.33°-21'W. 80.0 feet.

Thence N.1°-34'W.

15.0 Cross road, brs southeast to northwest.

420.0 Cross road, brs. southwest to northeast.

463.0 Cross road, brs. northwest to southeast.

613.0 Cross road, brs. southwest to northeast.

1500.0 TO COR. NO.3, a granite stone 8 x 12 x 26 inches long set fourteen inches in the ground with a substantial mound of stone alongside; chiseled O-3-3246A with cross on top for exact corner point, from which point,

A rock in place 3 x 2 x 1.5 feet exposed and chiseled BxR O-3-3246A, brs. N.40°-57'W. 42.0 feet.

A pine tree 20 inches in diameter and scribed BxT, O-3-3246A, brs. S.40°-58'W. 55.2 feet.

Thence N.54°-55'E.

359.8 NORTH CENTER END, a mound of stone.

719.6 TO COR. NO.4, identical with Cor. No.2 Iowa Lode of this survey, a granite stone 6 x 9 x 24 inches long set twelve inches in the ground with a substantial mound of stone alongside; chiseled O-4,I-2-3246A with cross on top for exact corner point, from which point,

The North Center End of the Surprise ~~Lode~~ No.2, lode, Sur.No.1718, brs. N.6°-01'E. 2886 feet.

No other bearings available.

Thence S.1°-34'E.

1030.0 Cross road, brs. northwest to southeast.

1187.0 Cross road, brs. northwest to southeast.

1500.0 TO THE PLACE OF BEGINNING. All corners are identical with their respective locations. Variation at all corners N.14°-25'E.

IOWA

Beginning at Cor. No.1, identical with Cors.No.1 of the Ohio, Indiana, and New York lodes of this survey and previously described, from which point,

U.S.M.M.No. 3246 brs. S.50°-58'E. 353.8 feet.

Thence N.1°-34'W.

313.0 Cross road, brs. northwest to southeast.

470.0 Cross road, brs. northwest to southeast.

1500.0 TO COR. NO. 2, identical with cor.No.4 Ohio lode of this survey previously described.

Thence N.75°-01'E.

308.4 NORTH CENTER END, a mound of stone.
 616.8 TO COR. NO.3, a granite stone 5 x 9 x 20 inches long set
 twelve inches in the ground with a substantial mound of
 stone alongside; chiseled I-3-3246A with cross on top for
 exact corner point, from which point,

A granite boulder 6 x 10 x 6 feet exposed and chi-
 seled BxR. I-3-3246A, brs. ^{55°-48'E} 101.7 feet.

A granite boulder 6 x 8 x 20 feet long and chiseled
 BxR I-3-3246A, brs. S.85°-39'E. 89.7 feet.

Thence S.1°-34'E.

835.2 Cor.No.2 Idaho Lode of this survey, hereinafter described.

1167.6 West Center end of Idaho Lode of this survey, a mound of
 stone.

1493.0 Witness Corner to Cor.No.1 Idaho lode, hereinafter described.

1500.0 TO POINT FOR COR.NO.4 on line 1-2 Indiana lode of this
 survey at N.75°-01'E. 616.8 feet from Cor. No.1, and
 identical with point for Cor. No.1 Idaho lode of this
 survey, where it was impracticable to set stone for cor-
 ner due to bed rock being close to the surface, so I esta-
 blished a witness corner at S.75°-01'W.22.7ft., a granite
 boulder 3 x 6 x 5 feet exposed and chiseled W C-I-4-3246A
 with cross for exact corner point,.

No. bearings available.

Thence S.75°-01'W.

22.7 Witness Corner to Cor. No.4, heretofore described.

308.4 SOUTH CENTER END, a mound of stone.

616.8 TO THE PLACE OF BEGINNING. All corners are identical with
 their respective locations. Variation at all corners N.14°-
 25'E.

IDAHO

Beginning at the point for Cor. No.1, identical with
 point for cor. No.4 Iowa lode of this survey, previously
 described, for which I established a witness corner at
 N.1°--34'W. 7.0 feet, a granite boulder 8 x 10 x 24 inches
 long set twelve inches in the ground chiseled W C-I-1-3246A
 with cross on top for exact cor.pt.From the true point for
 corner,
 A granite boulder 3 x 3 x 3 ft. exposed and chiseled

BxR I-1-3246A brs. N.75°-01'E. 7.2 feet.
 U.S.M.M.No. 3246, brs. S.40°-02'W. 499.0 feet.
 On line 1-2 Indiana lode of this survey S 75° of W. 883.2 ft. from Cor. No. 2.
 No other bearings available.

7.0 Thence N.1°-34'W.
 332.4 Witness Corner to Cor. No.1, this lode, previously described.
 WEST CENTER END, a mound of stone.

664.8 TO COR. NO.2, on line 3-4 Iowa lode of this survey, at
 S.1°-34'E. 835.2 feet from Cor. No.3, a granite stone
 10 x 10 x 27 inches long set twelve inches in the ground
 with a substantial mound of stone alongside; chiseled
 I-2-3246A with cross on top for exact corner point, from
 which point,

A pine tree 18 inches in diameter and scribed BxT,
 I-2-3246A, brs. S.31°-51'E. 104.8 ft.

No other bearings available.

Thence S.66°-02'E.

1500.0 TO COR.NO.3, a granite stone 6' x 12 x 20 inches long set
 twelve inches in the ground with a substantial mound of
 stone alongside; chiseled I-3-3246A with cross on top
 for exact corner point, from which point,

A granite rock in place 4 x 3 x 2 feet exposed and
 chiseled BxR, I-3-3246A, brs. S.47°-18'W. 49.5 feet.

No other bearings available.

Thence S.1°-34'E.

332.4 EAST CENTER END, a mound of stone.

664.8 TO COR. NO.4, a granite stone 6 x 12 x 27 inches long set
 twelve inches in the ground with a substantial mound of
 stone alongside; chiseled I-4-3246A with cross on top
 for exact corner point, from which point,

A rock in place 4 x 15 x 20 feet long, chiseled BxR
 I-4-3246A, brs. N.81°-46'W. 29.4 feet.

A granite rock in place 4 x 2 x 1 foot exposed and
 chiseled BxR I-4-3246A, brs. S.34°-45'W. 9.2 feet.

Thence N.66°-02'W.

547.9 Intersect line 2-3 Indiana Lode of this survey at S.1°-
 34'E. 615.3 feet from Cor. No.2.

1500.0 TO THE PLACE OF BEGINNING. All corners are identical with
 their respective locations. Variation at all corners N.14°

-25'E.

INDIANA

Beginning at Cor.No.1, identical with Cors.No.1, of the Ohio, Iowa and New York lodes of this survey, previously described, from which point,

U.S.M.M.NO.3246, brs. S.50°-58'E. 353.8 feet.

Thence N.75°-01'E.

- 308.4 South center end Iowa lode of this survey, previously described.
- 594.1 Witness Corner to Cor.No.4 Iowa lode of this survey
616.8 Point for corner No.4 Iowa lode, identical with point for corner No.1 Idaho lode of this survey, previously described.
- 624.0 Bearing rock to corner No.1 Idaho lode of this survey.
- 1500.0 TO COR. NO.2, a granite stone 4 x 12 x 19 inches long set twelve inches in the ground with a substantial mound of stone alongside; chiseled I-2-3246A with cross on top for exact corner point, from which point,
- A Juniper tree 24 inches in diameter and scribed BxT I-2-3246A brs. N.32°-43'W. 6.9 feet.
- A rock in place 20 x 5 x 3 feet exposed and chiseled BxR I-2-3246A, brs. S.13°-14'E. 56.1 feet.
- Thence S.1°-34'E.
- 308.4 EAST CENTER END, a mound of stone.
- 615.3 Intersect line 4-1 Idaho lode of this survey at S.66°-02'E. 952.1 feet from Cor. No.1.
- 616.8 TO COR. NO.3, a granite stone 8 x 12 x 26 inches long set twelve inches in the ground with a substantial mound of stone alongside; chiseled I-3-3246A with cross on top for exact corner point, from which point,
- A granite rock in place 3 x 2 x 1 foot exposed and chiseled BxR I-3-3246A, brs. N.11°-45'W. 37.3 feet.
- A granite rock in place 1 x 1 x 0.3 feet exposed and chiseled BxR, I-3-3246A, brs. N.26°-20'E. 22.8 feet.
- Thence S.75°-01'W.
- 1500.0 TO COR. NO.4, on line 1-2 New York Lode of this survey at S.1°-34'E. 616.8 feet from Cor. No.1, a granite stone 6x

12 x 27 inches long set twelve inches in the ground with a substantial mound of stone alongside; chiseled I-4-3246A with cross on top for exact corner point.

No bearings available.

Thence N.1°-34'W.

257.0 East center end New York Lode of this survey, a mound of stone.

308.4 WEST CENTER END, a mound of stone.

616.8 TO THE PLACE OF BEGINNING. All corners are identical with their respective locations. Variation at all corners N.14°-25'E.

NEW YORK

Beginning at Cor. No.1, identical with Cors. No.1 of the Ohio, Iowa and Indiana Lodes of this survey, previously described, from which point,

U.S.M.M.No.3246 brs. S.50°-58'E. 353.8 feet.

Thence S.1°-34'E.

308.4 West center end Indiana lode of this survey.

359.8 EAST CENTER END, a mound of stone.

616.8 Cor. No.4 Indiana Lode of this survey.

719.6 TO COR. NO.3, a granite stone 5 x 12 x 18 inches long set twelve inches in the ground with a substantial mound of stone alongside; chiseled N Y-2-3246A with cross on top for exact corner point, from which point,

A granite rock in place 10 x 8 x 3 feet exposed and chiseled BxR N Y-2-3246A, brs. N.15°-13'E. 20.3 feet.

A granite rock in place 3 x 3 x 1 foot exposed and chiseled BxR N Y-2-3246A, brs. N.88°-20'W. 57.3 feet.

Thence S.54°-55'W.

433.9 Intersect line 4-1 Good Luck Lode of this survey at S.78°-41'E. 556.5 feet from Cor. No.4.

1137.3 Intersect line 3-4 Good Luck Lode of this survey at S.3°-20'W. 514.4 feet from Cor. No.4.

1500.0 TO COR. NO.3, a granite stone 4 x 12 x 30 inches long, set fifteen inches in the ground with a substantial mound of

stone alongside; chiseled N Y-3-3246A with cross on top for exact corner point, from which point,

A granite boulder 8 x 8 x 10 feet exposed and chiseled BxR N Y-3-3246A brs. N.82°-33'E. 36.7 feet.

A juniper tree 22 inches in diameter and scribed BxT N Y-3-3246A, brs. S.89°-01'W. 76.1 feet.

Thence N.1°-34'W.

359.8 WEST CENTER END, a mound of stone.

719.6 TO COR. NO.4, a granite stone 5 x 9 x 22 inches long set twelve inches in the ground with a substantial mound of stone alongside; chiseled N Y-4-3246A, with cross on top for exact corner point, from which point,

A pine tree 18 inches in diameter and scribed BxT N Y-4-3246A, brs. S.55°-39'E. 55.5 feet.

A rock in place 1.5 x 1 x 1 foot exposed and chiseled BxR N Y-4-3246A brs. N.15°-09'W. 11.5 feet.

Thence N.54°-55'E.

780.4 Cor. No.2 Ohio Lode of this survey, previously described

791.0 Cross road, brs. southeast to northwest.

1140.2 South center end Ohio lode of this survey.

1500.0 TO THE PLACE OF BEGINNING. All corners are identical with their respective locations. Variation at all corners. N. 14°-25'E.

GOOD LUCK

Beginning at the point for Cor.No.1, where it was impracticable to set stone for corner due to bed rock being close to the surface, for which corner, I established a witness corner at N.78°-41'W. 3.8 feet, a granite rock in place 10 x 8 x 3 feet exposed and chiseled W C-G L-1-3246A with cross for exact corner point. From the true point for corner,

U.S.M.M.No. 3246 brs. N.18°-41'W. 982.8 feet

A granite rock in place 3 x 2 x 3 feet exposed and chiseled BxR G L-1-3246A, brs. N.40°-21'E. 16.9 feet.

No other bearings available.

Thence S.3°-20'W.

302.9 EAST CENTER END, a mound of stone.

605.8 TO COR. NO.2, a granite stone 6 x 15 x 18 inches long set twelve inches in the ground with a substantial mound of stone alongside; chiseled G L-2-3246A with cross on top for exact corner point, from which point,

A Granite Boulder 6 x 6 x 6 feet exposed and chiseled BxR G L-2-3246A, brs. N.33°-33'W. 60.9 feet.

No other bearings available.

Thence N.78°-41'W.

1500.0 TO COR. NO.3, a granite boulder 2 x 2 x 3 feet exposed with a substantial mound of stone alongside; chiseled G L-3-3246A with cross on top for exact corner point, from which point,

A juniper tree 24 inches in diameter and scribed BxT G L-3-3246A, brs. N.82°-57'W. 88.8 feet.

A granite boulder 8 x 10 x 10 feet exposed and chiseled BxR G L-3-3246A, brs. N.74°-07'E 42.5 feet.

Thence N.3°-20'E.

91.4 Intersect line 2-3 New York Lode of this survey at N.54°-55'E. 362.7 feet from Cor. No.3.

302.9 WEST CENTER END, a mound of stone.

605.8 TO COR. NO.4, a granite stone 8 x 12 x 24 inches long set twelve inches in the ground with a substantial mound of stone alongside; chiseled G L-4-3246A with cross on top for exact corner point, from which point,

A juniper tree 36 inches in diameter and scribed BxT G L-4-3246A, brs. N.76°-21'E. 89.0 feet.

No other bearings available.

Thence S.78°-41'E.

556.5 Intersect line 2-3 New York Lode of this survey at S.54°-55'W. 433.9 feet from Cor. No.2, and N.54°-55'E.1066.1 ft. from Cor.No.3 of said lode.

~~from its intersection with line 2-3 of this lode.~~

1496.2 Witness corner to Cor. No.1.

1500.0 TO THE PLACE OF BEGINNING. All corners are identical with their respective locations. Variation at all corners N. 14°-25'E.

INDIANA MILL-SITE

Beginning at Cor. No.1, identical with Cor. No.2 of the Oak Tree Mill-Site of this survey, a granite stone 6 x 10 x 30 inches long set twelve inches in the ground with a substantial mound of stone alongside; chiseled 1-I M S- 2 O T M S-3246B with cross on top for exact corner point, from which point,

A rock in place 15 x 10 x 4 feet exposed and chiseled BxR 1-I, 2-OTMS-3246B brs. N.38°-27'E. 29.0 feet.

An oak tree (forked) 18 inches in diameter and scribed BxT,IMS-1-3246B brs. N.16°-53'W. 25.8 feet.

Cor. No.4 Indiana Lode of this survey, brs. N.63°-25'-20"E. 2621.3 feet.

U.S.M.M.No. 3246, brs. N.58°-57'-10"E. 3037.4 feet.

Thence N.88°-36'W.

78.8 Cross fence brs. southwest to northeast.

90.0 Cross road, brs. southwest to northeast.

709.6 TO COR. NO.2, a granite stone, 8 x 12 x 27 inches long set twelve inches in the ground with a substantial mound of stone alongside; chiseled 2-IMS-3246B with cross on top for exact corner point, from which point,

A granite rock in place 15 x 10 x 10 feet exposed and chiseled BxR 2-IMS-3246B, brs. S.56°-51'E. 72.5 feet.

No other bearings available.

Thence S.7°-03'W.

42.0 Cross small wash flows easterly.

354.0 TO COR. NO.3, a granite stone 6 x 10 x 22 inches long set twelve inches in the ground with a substantial mound of stone alongside; chiseled 3-IMS-3246B with cross on top for exact corner point, from which point,

A juniper tree 8 inches in diameter and scribed BxT IMS-3-3246B, brs. N.67°-09'E.40.8 feet.

An oak tree 9 inches in diameter and scribed BxT IMS-3-3246B, brs. S.12°-0'E. 53.9 feet.

Thence N.83°-54'E.

142.0 Cross road brs. southwest to northeast.

- 156.0 Cross small wash flows northeasterly.
- 595.6 Cross fence at corner, brs. northeasterly and southeasterly.
- 725.0 TO COR. NO.4, on line 2-3 Oak Tree Mill-Site, a granite stone 6 x 10 x 24 inches long set twelve inches in the ground with a substantial mound of stone alongside; chiseled 4-IMS-3246B with cross on top for exact corner point, from which point,
 An oak tree 9 inches in diameter and scribed BxT 4-IMS-3246B, brs. S.89°-20'E. 62.5 feet.
 A pine tree 12 inches in diameter and scribed BxT 0 T-3, I-4-MS-3246B, brs. S.8°-10'W. 64.0 feet.
 Thence N.7°-03'E.
- 56.0 Cross 1 inch pipe line brs. northwest to southeast; also small wash flows southeasterly, ~~platted~~ identical with pipe line, from the well to garden tract.
- 259.0 TO THE PLACE OF BEGINNING. All corners are identical with their respective locations. Variation at all corners N.13°-50'E.
- OAK TREE MILL-SITE.
- Beginning at Cor.No.1, a granite stone 7 x 10 x 20 inches long set twelve inches in the ground with a substantial mound of stone alongside; chiseled 1-OTMS-3246B with cross on top for exact corner point, from which point,
 A juniper tree 20 inches in diameter and scribed BxT OTMS-1-3246B, brs. N.40°-42'E. 57.6 feet.
 An oak tree 16 inches in diameter and scribed BxT OTMS-1-4-3246B, brs. S.13°-55'E. 160.6 feet.
- Cor. No.3 Good Luck Lode of this survey, brs. N.46°-25'E. 899.0 feet.
 U.S.M.M.NO.3246 brs. N.44°-42'-50"E. 2619.1.feet.
 Thence N.68°-48'W.
- 360.0 Cross wire fence brs. southwest to northeast.
- 380.0 North end of dam, across wash.
- 434.0 Cross small wash, flows southeasterly.
- 814.7 TO COR. NO.2, identical with Cor.No.1 Indiana Mill-Site

of this survey, previously described.

Thence S.7°-03'W.

203.0 Cross 1 inch pipe line brs northwest to southeast; also small wash, flows southeasterly, platted identical with pipe line, from the well to garden tract.

259.0 Cor. No.4 Indiana Mill-Site of this survey.

317.9 Cross wire fence brs. southeast to northwest.

334.0 TO COR. NO.3, a granite stone 6 x 10 x 30 inches long set fifteen inches in the ground with a substantial mound of stone alongside; chiseled 3-OTMS-3246B with cross on top for exact corner point, from which point,

A pine tree 12 inches in diameter and scribed BxT
O T-3, I-4-MS-3246B, brs. N.0°-48'E. 11.0 feet.

No other bearings available.

Thence S.77°-31'E.

145.7 Cross wire fence brs. southeast to northwest.

344.7 Cross wire fence, brs. southwest to northeast.

437.7 Cross over galvanized iron tank, 8 feet in diameter and four feet deep.

793.9 TO COR. NO.4, a granite stone 8 x 8 x 22 inches long set twelve inches in the ground with a substantial mound of stone alongside; chiseled 4-OTMS-3246B with cross on top for exact corner point, from which point,

An oak tree 16 inches in diameter and scribed BxT
OTMS-1-4-3246B, brs. N.50°-21'E. 83.3 feet.

No other bearings available.

Thence N.6°-56'E.

140.0 Cross small wash flows easterly.

210.0 TO THE PLACE OF BEGINNING. All corners are identical with their respective locations. Variation at all corners N.13°-50'E.

LODE LINES

As near as can be determined from the present developments, the veins on the respective lodes extend as follows from their discoveries:

OHIO Lode

S.1°-34'E. 1138 ft. and N.1°-34'W. 362 feet.

IOWA Lode

S.1°-34'E. 591 feet and N.1°-34'W. 909 feet.

IDAHO Lode

S.66°-02'E. 1483 feet and N.66°-02'W. 17 feet.

INDIANA Lode

S.75°-01'W. 432 feet and N.75°-01'E. 1068 feet.

NEW YORK Lode

S.54°-55'W. 1130 feet and N.54°-55'E. 370 feet.

GOOD LUCK Lode

S.78°-41'E. 552.9' and N.78°-41'W. 947.1 feet.

AREAS

	Acres	Acres
OHIO Lode		
Total area - - - - -		20.659 ✓
IOWA Lode		
Total area - - - - -		20.659 ✓
IDAHO Lode		
Total area - - - - -		20.657 ✓
Area in conflict with		
Indiana lode, this survey	6.067 ✓	
INDIANA Lode		
Total area - - - - -		20.660 ✓
NEW YORK Lode		
Total area - - - - -		20.659 ✓
GOOD LUCK Lode		
Total area - - - - -		20.658 ✓
Area in conflict with		
New York Lode, this survey	3.253 ✓	
INDIANA Mill-Site		
Total area - - - - -		4.968 ✓
OAK TREE Mill-Site		
Total area - - - - -		4.932 ✓

LOCATION

This survey is located in Sec. 14, ~~and unsurveyed land in approximately~~ Section 15 ~~and 15~~, T.14 N.R.3 W. of the Gila and Salt River Base and Meridian, within the Prescott National Forest, Thumb Butte Mining District, Yavapai County, State of Arizona.

EXPENDITURE OF FIVE HUNDRED DOLLARS

I hereby certify that the value of the labor and improvements made upon, or for the benefit of each location embraced in said mining claims, by the claimants or their grantors is not less than five hundred dollars, and that said improvements consists of:

OHIO

No.1 Discovery Shaft, the center of which brs. S.1°-34'E. 362 feet from the north center end, 4 x 6 x 10 feet deep.

Value \$100.00

No.2 Cut and tunnel, the mouth of cut brs. N.13°-57'E. 478 feet from Cor. No. 2, Cut 4 x 20 x 12 foot face, and tunnel, 4 x 6 x 35 feet.

Value cut \$175.00
Tun. 350.00

No.3, Cut, the mouth of which brs. N.19°-30'E. 493 ft. from Cor. No.2, 4 x 17 x 9 foot face.

value \$125.00

To be credited to this claim is an equal undivided one fifth interest in workings of Improvement No.3 of Iowa Lode, as set forth under heading "Common Improvements".

Value \$2514.00

IOWA

No.1 Discovery shaft, the center of which brs. S.1°-34'E. 909 feet from north center end, 4 x 6 x 40 feet deep.

Value \$400.00

No.2, Shaft, the center of which brs. N.0°-30'W. 549 feet from South center end, 4 x 6 x 10 feet deep

Value. \$100.00

No.3, Tunnel, the mouth of cut brs. N.21°-50'E. 267 feet from Cor. No.1, 4 x 6^{ft} running S.22°-32'E. at 22 ft. face of cut and mouth of tunnel, 272 feet to sta. 1; thence S.37°-41'E. at 49 ft. drift to left 10 ft., 94.0 ft. to sta. 2; thence S.27°-15'E. 22.5 ft. to sta. 3; thence S.74°-48'W. at 8.0 ft. cross cut left 60 ft., 42 ft. upraise

to level above, 62.0 ft. to sta. 4; also ^{from Sta.3/} S.43°-15'E.
13.3 feet to sta. 5; thence from Sta.4 S.79°-10'W. at
12 ft. east end stope above, at 24 ft. west end stope, at
43 ft. cross cut to left 29 ft., with drifts 12 ft east a
and 5.0 ft. west from a point 13 ft from face; 71.0 ft.
to sta. 6; thence S.69°W. 96.7 feet to sta.7; thence
S.65°-20'W. 39.2 ft. to sta. 8; thence S.88°-10'W. 12.4
ft. to sta. 9; thence N.69°-30'W. 31 ft. to face of cross
cut, also from sta. 9 S.68°-00'W. 28.3 ft. to sta. 10;
thence N.68°-10'W. 45 ft. to face. From Sta. 5, running
S.43°-15'E. 15.4 ft to sta.15, also from sta. 5, N.47°-35'
E. 15 ft. to sta. 11; thence N.21°-30'E. 15.2 ft. to sta.
12; thence N.13°W 15 ft to face also N.85°-10'E. at 26 ft.
40 foot winze, 56.5 ft. to sta. 13; thence N.45°E. 27 ft.
to face. From Sta. 15, running S.54°-50'E. 54 ft. to sta.
16, thence S.41°-20'E. 115.5 ft. to face. having a total
length of tunnel of 1217.0 feet and winze 40 ft.

value tunnel	\$12170.00
" " Winze	400.00

To be credited to this claim is an equal undivided one
fifth interest in the above improvement, as set forth and
under heading "Common Improvements".

Value	\$2514.00
-------	-----------

IDAHO

No.1 Discovery cut, the center of which brs. S.66°-02'
E. 17 ft. from West center end, 4 x 19 x 8 foot face.

Value	\$100.00
-------	----------

No.2 Shaft, the center of which brs. N.9°-50'E. 465 ft.
from Cor. No.1, 4 x 6 x 10 feet deep

Value	\$100.00
-------	----------

No.3 Shaft, the center of which brs. N.16°-25'E. 442
ft. from Cor. No.1, 4 x 6 x 15 ft. deep.

Value	\$150.00
-------	----------

No.4 Shaft, the center of which brs. N.19°-15'E. 430
ft. from Cor. No.1, 4 x 6 x 10 ft. deep

Value	\$100.00
-------	----------

To be credited to this claim is an equal undivided one

fifth interest in the workings of Improvement No.3 Iowa lode, as set forth under heading "Common Improvements".

Value \$2514.00

INDIANA

No.1 Discovery shaft, the center of which brs. S.75°-01'W. 1068 ft. from east center end, 5 x 7 x 10 ft. deep

Value \$100.00

No.2, Shaft, the center of which brs. S.63°-07'W. 1175 ft. from Cor. No.2, 4 x 6 x 10 feet deep.

Value \$100.00

No.3, Tunnel, the mouth of cut brs. N.80°-23'E. 318 ft. from Cor. No.1, 4 x 6^{ft.} running ^{at} S.29°-30'E./17 ft. face of cut and mouth of tunnel, 144 ft. to sta. 1; thence S.19°-20'E. at 6.0 ft. upraise to surface in Improvement No.4, 12 ft. to sta. 3, also N.66°-20'E. 67 ft. to face, also S.73°-40'W. 41 ft. to sta. 4; thence from sta. 4 S.48°-25'W. 46 ft. to sta.5; thence S.65°-30'W. 25 ft. to face, and winze to level below. From Sta. 3 S.56°-30'W. 33 ft. to sta. 6; thence S.52°-0'W. 23 ft. to face, also S.49°-15'E. 53 ft. to face of cross cut, having a total length of tunnel of 444 ft. ^{O.K.}

Value \$4440.00

No.4 Shaft, the center of which brs. S.65°-53'W. 1130 ft. from Cor. No.2, 4 x 6 x 100 ft. deep.

value \$1000.00

To be credited to this claim is an equal undivided one fifth interest in the workings of Improvement No.3 Iowa lode as set forth under heading "Common Improvements".

Value \$2514.00

NEW YORK

No.1 Discovery shaft, the center of which brs. S.54°-55'W. 370 ft. from East center end, 4 x 6 x 100 ft. deep, inaccessible,

value \$1000.00

No.2 Tunnel and cut, the mouth of cut, brs. N.71°-35'E. 905 ft. from Cor. No.4, cut, 4 x 19 x 10 foot face and tunnel 4 x 6 x 300 ft.(estimated) as tunnel was caved and

inaccessible.

Value \$3000.00

To be credited to this claim is an equal undivided one fifth interest in the working of Improvement No.3 Iowa lode as set forth under heading "Common Improvements".

value \$2514.00

GOOD LUCK

No.1 Discovery Shaft, the center of which brs. S.78°-41' from the West Center End.
E. 947.1, 4 x 6 x 40 feet deep (caved)

value \$400.00

No.2 Cut and tunnel, the mouth of tunnel, brs. N.84°-05'W. 520 ft. from Cor. No.1, cut 4 x 36 x 14 foot face, and tunnel 4 x 6 x 36 ft. long,

Value	Cut	\$360.00
" "	Tun.	\$360.00

No.3, Shaft, the center of which brs: N.78°-41'W. 538 feet from east center end; 4 x 6 x 30 ft. deep (caved).

Value \$300.00

COMMON IMPROVEMENTS

Tunnel No.3 Iowa lode was run into the hill as a low level tunnel to intercept the the veins of the New York and Indiana lodes, and their intersection with the veins of Ohio, Iowa, and Idaho lodes. It has a depth of 300 feet under Indiana lode, and about 175 to 250 feet on the New York, Ohio, Iowa and Idaho lodes. The veins of the respective lodes at this elevation can best be developed from this improvement No.3, accordingly I consider the workings of said improvement, a common improvement, and of such character as to redound to the benefit of the Ohio, Iowa, Idaho, Indiana and New York Lodes. The Good Luck lode lies at a lower elevation than the above mentioned improvement, and accordingly this improvement does not redound to the benefit of said claim, and it should not share in the assignment of credits.

Total value of Improvement No.3 Iowa Lode \$12570.00

Value one fifth equal, undivided, interest \$2514.00

OTHER IMPROVEMENTS

Iowa Lode.

Ore bins, the northwest corner of which brs. N.8°-13'E.
385 feet from Cor. No.1

Shop, at Portal Improvement No.3, corrugated iron, 10 x10
feet.

Trestle connecting ore bin with tracks from Improvement
No.3.

Indiana Mill-Site.

Corrugated iron cabin, 10 x 12', the northeast corner
of which brs. S.20°-30'E, 192 ft.from Cor. No.2

Arastra, the center of which brs. S.28°-55'E. 247 ft.
from Cor. No.2.

Spring, walled up and initial point of pipe line, brs.
N.62°-06'E. 166 ft. from Cor. No.3. The pipe line is one
inch in diameter having a length of 1385 ft. running to
terminal point at the mill on Oak Tree Mill-Site.

A well 4x4 ft square, depth unknown, due to well being covered and inaccessible, the center of
which brs. S.66°00'E. 270 feet from Cor. No.2.

Oak Tree Mill-Site

A house, 14 x 30/^{ft.}with porch on three sides, frame, the
southwest corner of which brs. S.50°-11'E. 222.4 feet from
cor. No.2.

A barn, 12.5 x 23 feet, corrugated iron, the southwest
corner of which brs. S.52°-35'E. 114 ft.from Cor.No.2.

A garden fenced in, 25 x46', the southwest corner of
which brs. N.74°-37'E. 170 ft.from Cor. No.3

A galvanized iron tank, eight feet in diameter and
four feet deep, brs. S.77°-31'E. 437.7 ft. from Cor. No.3

A mill, the north end of which brs. N.46°-37'W. 210 ft.
from Cor. No.4, 8 x 20 foot frame, having crusher, grinder
and ten horse power gasoline engine, intact.

ADJOINING CLAIMS.

None.

INSTRUMENT.

This survey was made with a Lietz light Mountain
transit theodolite, No.13-5929. The ^ourses were deflected
from the true meridian as determined by observation by the

the use of Saegmuller Solar Attachment. The distances were measured with a 500 foot steel tape.

REPORT.

After diligent search I was unable to find any corners of the public survey within the boundaries of the township in which this survey is located, nor reliable corners within two miles of this survey. I accordingly established a U.S. Mineral Monument to which this survey was connected

The discrepancies found existing between the claims as marked by the location monuments and as described in the location notices are due to errors in the location notices.

William Coars
U.S. MINERAL SURVEYOR

WILLIAM COARS

U.S. MINERAL SURVEYOR

JAN 27 1916

DEC 2- 1915

FIELD NOTES
of
U.S.M.M 3246.

LOCATION

This monument is located on Mineral Hill in the Thumb Butte Mining District, Yavapai County Arizona, in Section 14 T.14 N.R.3 W of the Gila and Salt River Base and Meridian.

CONNECTIONS

U.S.M.M 3246 is a granite rock in place, 6 x 20 x 6 in. exposed and chiseled - U S M M 3246, with a monument of stone six foot base and six feet high alongside, which surrounds a juniper post eight feet long and six feet exposed. From the cross chiseled on rock for exact corner point;

A granite rock in place 2 x 2 x 1 ft. exposed and chiseled BxR-USMM-3246, brs. N.43°-03'E. 22.3 ft.

A granite rock in place 2 x 2 x 1 ft. exposed and chiseled BxR-USMM-3246, brs. N.76°-10'E. 38.0 ft.

A granite rock in place 3 x 6 x 1 ft. exposed and chiseled BxR-USMM-3246, brs. N.6°-46'W. 10.9 ft.

A shaft 4 x 6 x 90 ft deep brs. N.43°-50'E. 206 ft.

Cor.Nos.1 of the Ohio, Iowa, Indiana and New York lodes Sur.No.3246A brs. N.50°-58'W.353.8 ft.

Cor.No.1 Idaho lode Sur.No.3246A brs. N.40°-02'E. 499.0 ft.

The center of the north end of Trestle No.110, on the Santa Fe Prescott & Phoenix Railroad brs. S.51°-06'W. This trestle is located at Alto Station inside of the wye on the main line, and about 1.5 miles from monument.

The center of deep shaft north of railroad known as the Last Chance Mine, brs. S.30°-14'W. about 0.8 miles.

The highest point at center of Thumb Butte, brs. S.24°-36'E. 3.8 miles

The west gable end of Wagon shed west of county road on the "Burnt Ranch" brs. S.82°-54'E. about 3.5 miles.

The highest peak on Granite Mountain, brs. N.8°-26'W. about 3.5 miles.

The south end of Trestle No. 101 on the Santa Fe Prescott and Phoenix Railroad, Brs.S.35°-56'E. about 2.0 miles.

The center of entrance to new high school building, Prescott, Arizona. brs. S.51°-36'E. about. 5.8 miles. This point of the building is located about 75 feet south of the the line between Ts. 13 and 14 N.R.2 W. and about 480 feet west of the corner to sections 3-4, 33-34 of the respective townships.

REPORT

There are no corners of the public survey within two miles of this monument, which can be found or identified, nor are there any corners of the public survey within the boundaries of the township in which it is located, that

*Blaine Ranch
on former street*

can be found and identified. The above was determined after diligent search and inquiry, which result in the establishment of U.S. Mineral Monument No. 3246.

insert

William Waase
U.S. MINERAL SURVEYOR.

Oct. 28, 1915.

From the cross chiseled on rock for exact corner point of U.S.M.M. 3246, the 1/4 corner between sections 17 and 18 T. 14 N.R.2 W. brs. S.89°-28'-30"E. 13,756.6 feet.

The 1/4 corner between sections 17 and 18, T.14 N.R.2 W, is a granite stone properly set and chiseled 1/4 on its west face.

FINAL OATHS FOR SURVEYS.

LIST OF NAMES.

A list of the names of the individuals employed by J. WILLIAM WAARA

United States ~~Deputy~~ Mineral Surveyor, to assist in running, measuring, and marking the lines, corners, and boundaries described in the foregoing field notes of the survey of the mining claim of Joseph Dougherty and H. C. Dreis.

NEW YORK, INDIANA, OHIO, IOWA, GOOD LUCK, IDAHO LODES, AND
known as the INDIANA, OAK TREE MILL-SITES

and showing the respective capacities in which they acted.

J. N. WESTON....., *Chainman.*

....., *Chainman.*

....., *Arman.*

....., *Flagman.*

FINAL OATHS OF ASSISTANTS.

~~WX~~ I, J. N. Weston

~~XXXX~~....., do solemnly swear ~~XXXXXX~~ that I assisted J. WILLIAM WAARA

....., United States ~~Deputy~~ Mineral Surveyor, in marking the corners and surveying the boundaries of the mining claim of JOSEPH DOUGHERTY, AND H. C. DREIS, known as the

NEW YORK, INDIANA, OHIO, IOWA, GOOD LUCK IDAHO LODES, AND

~~XXXXXXXXXX~~ INDIANA, OAK TREE MILL-SITES

represented in the foregoing field notes as having been surveyed by said ~~deputy~~ mineral surveyor and under his direction; and that said survey has been in all respects, to the best of our knowledge and belief, faithfully and correctly executed, and the corner and boundary monuments established according to law and the instructions furnished by the United States Surveyor-General for ARIZONA.

J. N. Weston....., *Chainman.*

....., *Chainman.*

....., *Arman.*

....., *Flagman.*

Subscribed and sworn to by the above-named persons before me this 18 th.

day of OCTOBER 1915, 190.....

[Signature]

Notary Public

(4-686.)

FINAL OATH OF U. S. ~~DEPUTY~~ MINERAL SURVEYOR

I, J. WILLIAM WAARA, U. S. ~~Deputy~~ Mineral Surveyor, do solemnly swear that, in pursuance of instructions received from the United States Surveyor General for ARIZONA, dated OCTOBER 6, 1915, I have, in strict conformity to the laws of the United States, the official regulations and instructions thereunder, and the instructions of said Surveyor General, faithfully and correctly executed the survey of the Mining Claim of JOSEPH DOUGHERTY AND H.C. DREIS, KNOWN AS THE NEW YORK, INDIANA, OHIO, IOWA, IDAHO, GOOD LUCK LODES AND, ~~XXXXXXXXXX~~ INDIANA, OAK TREE MILL-SITES, situate in THUMB BUTTE Mining District, YAVAPAI County, ARIZONA, in Sections 14 & 15, Township No. 14 N., Range No. 3 W. and designated as Survey No. 3246 A&B, as represented in the foregoing field notes, which accurately show the boundaries of said mining claim as distinctly marked by monuments on the ground, and described in the attached copy of the location certificate, which was received by me from the Surveyor General with said instructions, and that all the corners of said survey have been established and perpetuated in strict accordance with the law, official regulations and instructions thereunder; and I do further solemnly swear that the foregoing are the true and original field notes of said survey and my report therein, and that the labor expended and improvements made upon said mining claim by claimants or their grantors are as therein fully stated, and that the character, extent, location and itemized value thereof are specified therein with particularity and full detail, and that no portion of said labor or improvements so credited to this claim has been included in the estimate of expenditures upon any other claim.

J. William Waara
 U. S. ~~Deputy~~ Mineral Surveyor.

Subscribed and sworn to by the said J. WILLIAM WAARA
 U. S. ~~Deputy~~ Mineral Surveyor, before me J. S. Brown
a Notary Public this 18 th.
 day of OCTOBER 1915,

J. S. Brown

NOTARY PUBLIC.

o 8-154

My commission expires Feb. 19-1916-

Notice of Mining Location

LODE CLAIM

TO ALL WHOM IT MAY CONCERN:

This Mining Claim, the name of which is the NEW YORK,
Mining Claim, situate on lands belonging to the United States of America, and in which there are valuable
mineral deposits, was entered upon and located for the purposes of exploration and purchase by

Joseph Dougherty and H.C.Dreis, both citizens of the
United States,

Locator must insert either "a citizen of the United States," or "who has declared his intention to become a citizen of the United States."

the undersigned, on the 1st., day of Oct., 1915.

The length of this claim is 1500 feet,
and we claim 370 feet,

in a northeasterly direction and 1130
feet in a southwesterly direction from
the center of the discovery shaft, at which this notice is posted, lengthwise of the claim, together with
300 feet in width of the surface grounds, on each
side of the center of said claim. The general course of the lode deposit and premises is from the
southwest to the northeast

The claim is situated and located in the Thumb Butte, Mining District, in
Yavapai County, in the State of Arizona, about 1, 1/2 miles,
in a northeasterly direction from Alto Station, on S.F.P. & P.
Railroad.

The surface boundaries of the claim are marked upon the ground as follows: Beginning at
a monument of stone,

at a point in a northeasterly direction 370 feet from
the discovery shaft (at which this notice is posted,) being in the center of the easterly
end line of said claim; thence S.1°-34' E. 359.8 feet to a mon.of stone
S.E. corner of said claim;
thence S.54°-55' W. 1500.0 feet to a mon.of stone, being at the
S.W. corner of said claim; thence N.1°-34' W. 359.8 feet
to a mon.of stone, at the center of the westerly end of said claim;
thence N.1°-34' W. 359.8 feet to a mon.of stone, being at the
N.W. corner of said claim; thence N.54°-55' E. 1500.0
feet to a mon.of stone, at the N.E. corner of said claim;
thence S.1°-34' E. 359.8 feet to the place of the beginning.

All done under the provisions of Chapter Six, of Title XXXII, of the Revised Statutes of the United
States, and of an Act of the General Assembly of Arizona, entitled "An Act to Revise and Codify the Laws
of the Territory of Arizona." approved March 16, 1901.

This is an Amended Location Notice of the NEW NEW YORK,
Mining Claim, located by Joseph Dougherty and Charles Schmidt,
on the 17th., day of
Feb., 1903, and recorded in Book 67, of Records of Mines, at
page 101, in the office of the County Recorder of the aforesaid County of Yavapai,
to which reference is hereby made, and this Amended Location Notice is made and posted to correct errors
in the description in the said Original Location Notice.

Dated and posted on the ground this 1st., day of Oct., 1915.

Witness. { Lee Wilson. { Joseph Dougherty.
... { J.N.Weston. { H.C.Dreis.

2
26

AMENDED
Notice of Mining Location
LODE CLAIM

TO ALL WHOM IT MAY CONCERN:

This Mining Claim, the name of which is the INDIANA,
Mining Claim, situate on lands belonging to the United States of America, and in which there are valuable mineral deposits, was entered upon and located for the purposes of exploration and purchase by Joseph Dougherty and H.C.Dreis, both citizens of the United States,

Locator must insert either "a citizen of the United States," or "who has declared his intention to become a citizen of the United States."

the undersigned, on the 1st., day of Oct., 1915.

The length of this claim is 1500 feet,
and we claim 432 feet,
in a westerly direction and 1168

feet in a easterly direction from the center of the discovery shaft, at which this notice is posted, lengthwise of the claim, together with 300 feet in width of the surface grounds, on each side of the center of said claim. The general course of the lode deposit and premises is from the westerly to the easterly

The claim is situated and located in the Thumb Butte, Mining District, in Yavapai County, in the State of Arizona, about 1,3/4 miles in a northeasterly direction from Alto Station, on the S.F.P.& P. Railroad.

The surface boundaries of the claim are marked upon the ground as follows: Beginning at a mon.of stone,

at a point in a westerly direction 432 feet from the discovery shaft (at which this notice is posted,) being in the center of the westerly end line of said claim; thence N.1°-34' W. 308.4 feet to a mon.of stone, being the N.W. corner of said claim; thence N.75°-01' E. 1500.0 feet to a Juniper Post 4"X4"X4, 1/2' being at the N.E. corner of said claim; thence S.1°-34' E. 308.4 feet to a mon.of stone, at the center of the easterly end of said claim; thence S.1°-34' E. 308.4 feet to a mon.of stone, being at the S.E. corner of said claim; thence S.75°-01' W. 1500.0 feet to a mon.of stone, at the S.W. corner of said claim; thence N.1°-34' W. 308.4 feet to the place of the beginning.

All done under the provisions of Chapter Six, of Title XXXII, of the Revised Statutes of the United States, and of an Act of the General Assembly of Arizona, entitled "An Act to Revise and Codify the Laws of the Territory of Arizona." approved March 16, 1901.

This is an Amended Location Notice of the INDIANA,
Mining Claim, located by Joseph Dougherty and Charles Schmidt,
on the 17th., day of Feb., 1903,
and recorded in Book 67, of Records of Mines, at page 99, in the office of the County Recorder of the aforesaid County of Yavapai,
to which reference is hereby made, and this Amended Location Notice is made and posted to correct errors in the description in the said Original Location Notice.

Dated and posted on the ground this 1st., day of Oct., 1915.

Witness.

....

J.N.Weston.

Lee Wilson.

Joseph Dougherty.

H.C.Dreis.

I, County Recorder in and for the County and State aforesaid, do hereby certify that the within instrument was filed for record at o'clock M., on this day of, 191....., and duly recorded in Book No..... of Records of County, Arizona, at pages.....

Witness my hand and official seal the day and year first above written.

..... County Recorder.

2379.

AMENDED

Notice of Location

LODE CLAIM

Filed and Recorded at request of Joseph Dougherty, Oct., 4th., A. D. 1915, at 4:35- O'clock P.M. Book 86 of Mines, Page 524; Records of Yavapai County, Arizona.

(SEAL.) L.S. Colwell, County Recorder.

E.A. Moswigin, Deputy Recorder.

Printed and for sale by the Prescott Courier

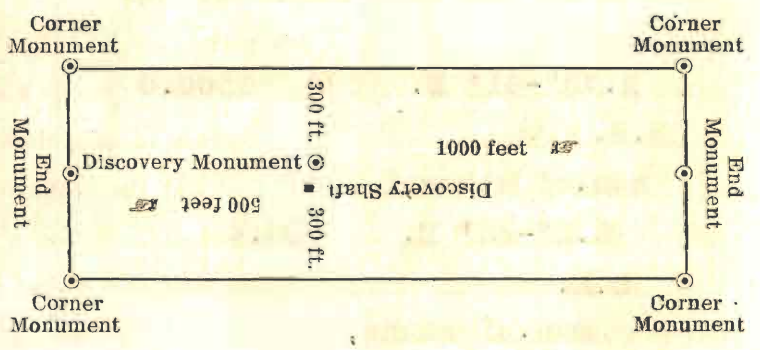

This diagram is to give locator a general idea of plan of location under the new law. The Discovery Shaft can be in the center of claim or any distance from either end desired. In the diagram it is placed 500 feet from one end and 1000 feet from the other. Commence description of claim at a center end monument, giving its distance and direction from center of Discovery Shaft; thence bound the claim in either direction. In description be careful to state locality of claim with reference to some natural object, or permanent monument, as will identify the claim.

3
28

AMENDED
Notice of Mining Location
LODE CLAIM

TO ALL WHOM IT MAY CONCERN:

This Mining Claim, the name of which is the IOWA
Mining Claim, situate on lands belonging to the United States of America, and in which there are valuable mineral deposits, was entered upon and located for the purposes of exploration and purchase by Joseph Dougherty and H.C.Dreis, both citizens of the United States,

Locator must insert either "a citizen of the United States," or "who has declared his intention to become a citizen of the United States."

the undersigned, on the 1st., day of Oct., 1915.
The length of this claim is 1500 feet,
and we claim 591 feet,
in a southerly direction and 909

feet in a northerly direction from
the center of the discovery shaft, at which this notice is posted, lengthwise of the claim, together with 300 feet in width of the surface grounds, on each side of the center of said claim. The general course of the lode deposit and premises is from the southerly to the northerly

The claim is situated and located in the Thumb Butte, Mining District, in Yavapai County, in the State of Arizona, about 1,3/4 miles in a northeasterly direction from Alto Station, on the S.F.P. & P. Railroad.

The surface boundaries of the claim are marked upon the ground as follows: Beginning at a mon. of stone,

at a point in a southerly direction 591 feet from the discovery shaft (at which this notice is posted,) being in the center of the southerly end line of said claim; thence S.75°-01' W. 308.4 feet to a mon. of stone, being the S.W. corner of said claim; thence N.1°-34' W. 1500.0 feet to a mon. of stone, being at the N.W. corner of said claim; thence N.75°-01' E. 308.4 feet to a mon. of stone, at the center of the northerly end of said claim; thence N.75°-01' E. 308.4 feet to a mon. of stone, being at the N.E. corner of said claim; thence S.1°-34' E. 1500.0 feet to a mon. of stone at the S.E. corner of said claim; thence S.75°-01' W. 308.4 feet to the place of the beginning.

All done under the provisions of Chapter Six, of Title XXXII, of the Revised Statutes of the United States, and of an Act of the General Assembly of Arizona, entitled "An Act to Revise and Codify the Laws of the Territory of Arizona," approved March 16, 1901.

This is an Amended Location Notice of the IOWA,
Mining Claim, located by Joseph Dougherty and Charles Schmidt,
on the 17th., day of Feb., 1903, and recorded in Book 67 of Records of Mines, at page 102, in the office of the County Recorder of the aforesaid County of Yavapai, to which reference is hereby made, and this Amended Location Notice is made and posted to correct errors in the description in the said Original Location Notice.

Dated and posted on the ground this 1st., day of Oct., 1915.

Witness.	}	<u>Lee Wilson.</u>	}	<u>Joseph Dougherty.</u>
		<u>J.N.Weston.</u>		<u>H.C.Dreis.</u>

30
6075-1915

AMENDED
Notice of Mining Location
LODE CLAIM

TO ALL WHOM IT MAY CONCERN:

This Mining Claim, the name of which is the IDAHO,
Mining Claim, situate on lands belonging to the United States of America, and in which there are valuable
mineral deposits, was entered upon and located for the purposes of exploration and purchase by
Joseph Dougherty and H.C.Dreis, both citizens of the
United States,

Locator must insert either "a citizen of the United States," or "who has declared his intention to become a citizen of the United States."

the undersigned, on the 1st., day of Oct., 1915.
The length of this claim is 1500 feet,
and we claim 17 feet,
in a northwesterly direction and 1483
feet in a southeasterly direction from
the center of the discovery shaft, at which this notice is posted, lengthwise of the claim, together with
300 feet in width of the surface grounds, on each
side of the center of said claim. The general course of the lode deposit and premises is from the
southeasterly to the northwesterly
The claim is situated and located in the Thumb Butte, Mining District, in
Yavapai County, in the State of Arizona, about 1, -7/8 miles
in a northeasterly direction from Alto Station, on the S.F.P. & P.
Railroad.

The surface boundaries of the claim are marked upon the ground as follows: Beginning at
a mon. of stone,
at a point in a northwesterly direction 17 feet from
the discovery shaft (at which this notice is posted,) being in the center of the westerly
end line of said claim; thence N.1°-34' W. 332.4 feet to a mon. of stone
of stone, being the N.W. corner of said claim;
thence S.66°-02' E. 1500.0 feet to a mon. of stone, being at the
N.E. corner of said claim; thence S.1°-34' E. 332.4 feet
to a mon. of stone, at the center of the easterly end of said claim;
thence S.1°-34' E. 332.4 feet to a mon. of stone, being at the
S.E. corner of said claim; thence N.66°-02' W. 1500.0
feet to a mon. of stone, at the S.W. corner of said claim;
thence N.1°-34' W. 332.4 feet to the place of the beginning.

All done under the provisions of Chapter Six, of Title XXXII, of the Revised Statutes of the United
States, and of an Act of the General Assembly of Arizona, entitled "An Act to Revise and Codify the Laws
of the Territory of Arizona," approved March 16, 1901.

This is an Amended Location Notice of the IDAHO,
Mining Claim, located by Joseph Dougherty and Charles Schmidt,
on the 17th., day of
Feb., 1903, and recorded in Book 67 of Records of Mines, at
page 100, in the office of the County Recorder of the aforesaid County of Yavapai,
to which reference is hereby made, and this Amended Location Notice is made and posted to correct errors
in the description in the said Original Location Notice.

Dated and posted on the ground this 1st., day of Oct., 1915.

Witness. { Lee Wilson.

{ J.N.Weston.

{ Joseph Dougherty.

{ H.C.Dreis.

ss.

County of

I, County Recorder in and for the County and State aforesaid, do hereby certify that the within instrument was filed for record at o'clock M., on this day of, 191....., and duly recorded in Book No..... of Records of County, Arizona, at pages.....

Witness my hand and official seal the day and year first above written.

County Recorder.

2376.

AMENDED

Notice of Location

LODGE CLAIM

Filed and Recorded at request of
Dated 191.....
Joseph Dougherty.

Oct., 4th., A. D. 1915.
at 4:35- O'clock, P. M.

Book 86 of Mines,

Page 521; Records of Yavapai

County, Arizona.

(SEAL.) I.S. Colwell,
County Recorder.

By E.A. Mosvickin,
Deputy Recorder.

Printed and for sale by the Prescott Courier

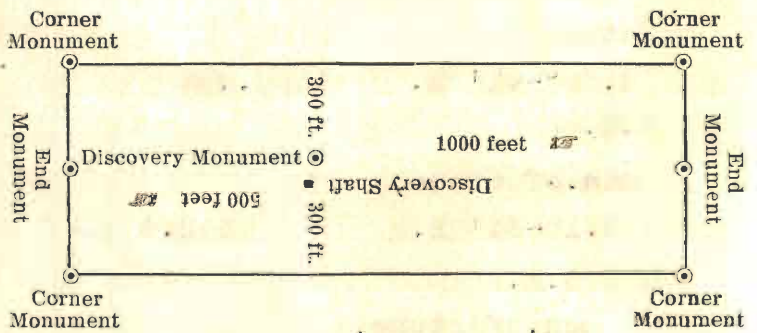

This diagram is to give locator a general idea of plan of location under the new law. The Discovery Shaft can be in the center of claim or any distance from either end desired. In the diagram it is placed 500 feet from one end and 1000 feet from the other. Commence description of claim at a center end monument, giving its distance and direction from center of Discovery Shaft; thence bound the claim in either direction. In description be careful to state locality of claim with reference to some natural object, or permanent monument, as will identify the claim.

32

AMENDED
Notice of Mining Location
LODE CLAIM

TO ALL WHOM IT MAY CONCERN:

This Mining Claim, the name of which is the OHIO,
Mining Claim, situate on lands belonging to the United States of America, and in which there are valuable
mineral deposits, was entered upon and located for the purposes of exploration and purchase by
Joseph Dougherty and H.C.Dreis, both citizens of the
United States,

Locator must insert either "a citizen of the United States," or "who has declared his intention to become a citizen of the United States."

the undersigned, on the 1st., day of Oct., 1915.

The length of this claim is 1500 feet,
and we claim 362 feet,
in a northerly direction and 1138

feet in a southerly direction from
the center of the discovery shaft, at which this notice is posted, lengthwise of the claim, together with
300 feet in width of the surface grounds, on each
side of the center of said claim. The general course of the lode deposit and premises is from the
southerly to the northerly

The claim is situated and located in the Thumb Butte, Mining District, in
Yavapai County, in the State of Arizona, about 1, 5/8 miles
in a northeasterly direction from Alto Station, on the S.F.P. & P.
Railroad,

The surface boundaries of the claim are marked upon the ground as follows: Beginning at
a mon. of stone,

at a point in a southerly direction 1138, feet from
the discovery shaft (at which this notice is posted,) being in the center of the
end line of said claim; thence S. 54°-55' W. 359.8 feet to a mon. of stone
.. .. ., being the S.W. corner of said claim;
thence N. 1°-34' W. 1500.0 feet to a mon. of stone, being at the
N.W. corner of said claim; thence N. 54°-55' E. 359.8 feet
to a mon. of stone, at the center of the northerly end of said claim;
thence N. 54°-55' E. 359.8 feet to a mon. of stone, being at the
N.E. corner of said claim; thence S. 1°-34' E. 1500.0
feet to a mon. of stone, at the S.E. corner of said claim;
thence S. 54°-55' W. 359.8 feet to the place of the beginning.

All done under the provisions of Chapter Six, of Title XXXII, of the Revised Statutes of the United
States, and of an Act of the General Assembly of Arizona, entitled "An Act to Revise and Codify the Laws
of the Territory of Arizona," approved March 16, 1901.

This is an Amended Location Notice of the OHIO.
Mining Claim, located by Joseph Dougherty and Charles Schmidt,
.. .. . on the 17th., day of
Feb., 1903, and recorded in Book 67, of Records of Mines, at
page 104, in the office of the County Recorder of the aforesaid County of Yavapai,
to which reference is hereby made, and this Amended Location Notice is made and posted to correct errors
in the description in the said Original Location Notice.

Dated and posted on the ground this 1st., day of Oct., 1915.

Witness. {
... { Lee Wilson.
H.C.Dreis.

{ Joseph Dougherty.
H.C.Dreis.

County of

ss.

I, County Recorder in and for the County and State aforesaid, do hereby certify that the within instrument was filed for record ato'clock.....M., on this day of, 191....., and duly recorded in Book No..... of Records of County, Arizona, at pages.....

Witness my hand and official seal the day and year first above written.

County Recorder.

AMENDED

Notice of Location

LODE CLAIM

Dated 191.....
Filed and Recorded at request of
Joseph Dougherty,
Oct., 4th., A. D. 1915.
at 4:35- 0'clock, P.M.
Book 86 of Mines,
Page 522; Records of Yavapai County, Arizona.

(SEAL.) L.S. Colwell,
County Recorder.

By E.A. McSwiggan,
Deputy Recorder.

Printed and for sale by the Prescott Courier

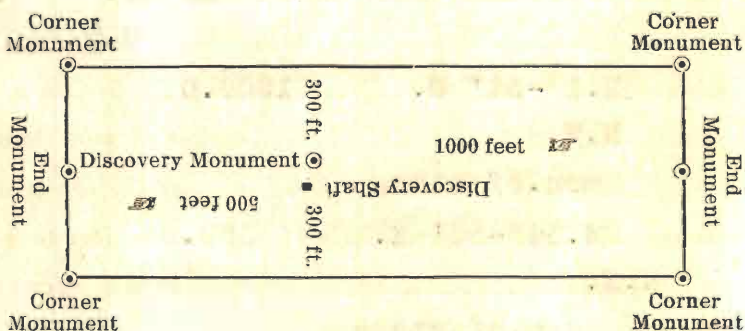

This diagram is to give locator a general idea of plan of location under the new law. The Discovery Shaft can be in the center of claim or any distance from either end desired. In the diagram it is placed 500 feet from one end and 1000 feet from the other. Commence description of claim at a center end monument, giving its distance and direction from center of Discovery Shaft; thence bound the claim in either direction. In description be careful to state locality of claim with reference to some natural object, or permanent monument, as will identify the claim.

6
34

AMENDED
Notice of Mining Location
LODE CLAIM

TO ALL WHOM IT MAY CONCERN:

This Mining Claim, the name of which is the GOODLUCK,
Mining Claim, situate on lands belonging to the United States of America, and in which there are valuable
mineral deposits, was entered upon and located for the purposes of exploration and purchase by
Joseph Dougherty and H.C.Dreis, both citizens of the United
States,

Locator must insert either "a citizen of the United States," or "who has declared his intention to become a citizen of the United States."

the undersigned, on the 1st., day of Oct., 1915.
The length of this claim is 1500 feet,
and we claim 546 feet,
in a easterly direction and 954
feet in a westerly direction from
the center of the discovery shaft, at which this notice is posted, lengthwise of the claim, together with
300 feet in width of the surface grounds, on each
side of the center of said claim. The general course of the lode deposit and premises is from the
easterly to the westerly
The claim is situated and located in the Thumb Butte, Mining District, in
Yavapai County, in the State of Arizona, about 1, 1/2 miles,
in a northeasterly direction from Alto Station, on the S.F.P. & P.
Railroad.

The surface boundaries of the claim are marked upon the ground as follows: Beginning at
a mon. of stone,
at a point in a westerly direction 954 feet from
the discovery shaft (at which this notice is posted,) being in the center of the westerly
end line of said claim; thence N. 3°-20' E. 302.9 feet to a mon. of stone,
being the N.W. corner of said claim;
thence S. 78°-41' E. 1500.0 feet to a mon. of stone, being at the
N.E. corner of said claim; thence S. 3°-20' W. 302.9 feet
to a mon. of stone, at the center of the easterly end of said claim;
thence S. 3°-20' W. 302.9 feet to a mon. of stone, being at the
S.E. corner of said claim; thence N. 78°-41' W. 1500.0
feet to a mon. of stone, at the S.W. corner of said claim;
thence N. 3°-20' E. 302.9 feet to the place of the beginning.

All done under the provisions of Chapter Six, of Title XXXII, of the Revised Statutes of the United
States, and of an Act of the General Assembly of Arizona, entitled "An Act to Revise and Codify the Laws
of the Territory of Arizona," approved March 16, 1901.

This is an Amended Location Notice of the GOODLUCK,
Mining Claim, located by Joseph Dougherty and Charles Schmidt,
on the 17th., day of
Feb., 1903, and recorded in Book 67 of Records of Mines, at
page 103, in the office of the County Recorder of the aforesaid County of Yavapai,
to which reference is hereby made, and this Amended Location Notice is made and posted to correct errors
in the description in the said Original Location Notice.

Dated and posted on the ground this 1st., day of Oct., 1915.

Witness.	{	<u>J.N.Weston.</u>	{	<u>Joseph Dougherty,</u>
		<u>Lee Wilson.</u>		<u>H.C.Dreis.</u>

County of

I, County Recorder in and for the County and State aforesaid, do hereby certify that the within instrument was filed for record ato'clock.....M., on this day of, 191....., and duly recorded in Book No..... of Records of County, Arizona, at pages.....

Witness my hand and official seal the day and year first above written.

County Recorder.

AMENDED
LODE CLAIM
Notice of Location

Dated 191.....
Filed and Recorded at request of

Joseph Dougherty.

Oct., 4th., A. D. 1915.

at 4:35- 0'clock, P. M.

Book 96 of Mines.

Page 526:Records of Yavapai County, Arizona.

(SEAL.) L.S. Colwell,
County Recorder.

By E.A. McSwiggin,
Deputy Recorder.

Printed and for sale by the Prescott Courier

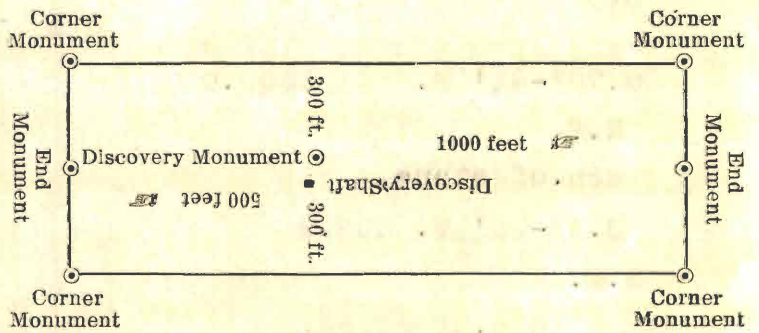

This diagram is to give locator a general idea of plan of location under the new law. The Discovery Shaft can be in the center of claim or any distance from either end desired. In the diagram it is placed 500 feet from one end and 1000 feet from the other. Commence description of claim at a center end monument, giving its distance and direction from center of Discovery Shaft; thence bound the claim in either direction. In description be careful to state locality of claim with reference to some natural object, or permanent monument, as will identify the claim.

CLAIM
LOCATION NOTICE OF THE INDIANA MILL-SITE AND WATER RIGHT.

KNOW ALL MEN BY THESE PRESENTS,- That we the undersigned, have this day AMENDED the location of a MILL-SITE, for the purpose of erecting suitable works for reducing the ores of the INDIANA Mining Claim, situated in the Thumb Butte Mining District, Yavapai County, State of Arizona.

The exterior boundaries of said INDIANA Mill-Site Claim, are as follows, viz:-

Commencing at a monument of stone, at the S.W. Corner of Claim, and running thence N. 83°-54' E. 725.0 feet, to a monument of stone at the S.E. Corner of claim; thence N. 7°-03' E. 259 feet, to a monument of stone, at the N.E. Corner of claim; thence N. 88°-36' W. 709.6 feet, to a monument of stone at the N.W. Corner of claim; thence S. 7°-03' W. 354 feet, to the S.W. Corner, and the place of beginning.

That we have, also, located in connection with the said Mill-Site claim, TWO inches miner's measure or all of the water of the Spring thereon under and in accordance with the LAWS of the State of Arizona, regulating the location and possession of Water Rights for Mining, Milling and Domestic purposes.

This is an AMENDED LOCATION NOTICE of the INDIANA MILL-SITE, located by Chas. Schmidt and Joseph Dougherty on the 25th., day of December, 1906, and Recorded in Book 5, of Mill-Sites and Water Rights, at pages 337 and 338, and of the ALTO SIDING Mill-Site, located by Charles Schmidt on the 7th., day of June, 1913, and Recorded in Book 4, of Mill-Sites and Water Rights, at Page 276, in the Office of the County Recorder, of the aforesaid County of Yavapai, to which reference is hereby made, and this Amended Location Notice, is made and posted to correct errors in the description, in the said original Location Notices, and to reduce area of Mill-Site Claims.

Dated and posted on the ground, this 4th., day of October, 1915.

Witness :
J.N.Weston.

Joseph Dougherty.

H.C.Dreis.

Filed and Recorded, at request of Joseph Dougherty, Oct., 4th., A.D., 1915, at 4:35-0'clock P.M., Book 7, Mill-Sites & Water Rights, Pages 85-86 ; Records of Yavapai County, Arizona.

L.S.Colwell,
County Recorder.

BY, -E.A.McSwiggin, Deputy Recorder. (SEAL.)

#####

LOCATION OF THE OAK TREE, - MILL-SITE CLAIM, AND WATER RIGHT.

KNOW ALL MEN BY THESE PRESENTS, -That we the undersigned, have this day AMENDED the location of a Mill-Site for the purpose of erecting suitable works for reducing the ores of the GOOD LUCK, Mining Claim, situated in the Thumb Butte Mining District, Yavapai County, State of Arizona.

The exterior boundaries of said Oak Tree Mill-Site Claim, are as follows, viz:-

Commencing at a monument of stone at the N.W. Corner of claim, and running thence S.7°-03'W.334 feet to a monument of stone at the S.W. Corner of claim; thence S.77°-31'E.793.5 feet to a monument of stone at the S.E. Corner of claim; thence N.7°-03'E.210 feet to a monument of stone, at the N.E. Corner of claim; thence N.68°-48'W.814.7 feet to the N.W. Corner and the place of beginning.

That we have, also, located in connection with the said Mill-Site Claim, ten (10) inches miner's measure, or all of the waters of the Spring and Wash, flowing through said claim; UNDER AND in accordance with the laws of the State of Arizona, regulating the location and possession of water rights, for Mining, Milling and Domestic purposes.

This is an AMENDED LOCATION NOTICE, of the OAK TREE, -MILL-SITE, located by H.C.Dreis on the 24th., day of September, 1913, and Recorded in Book 4, of Mill-Sites and Water Rights, at Page 280, and of the ALTO SIDING Mill-Site, located by Charles Schmidt, on the 7th., day of June, 1913, and Recorded in Book 4, of Mill-Sites and Water Rights, at Page 276, in the Office of the County Recorder, of the aforesaid County of Yavapai, to which reference is hereby made, and this Amended Location Notice is made and posted to correct errors in the description in the said Original Location Notices, and to reduce area of Mill-Site Claims.

Dated and posted on the ground this 4th., day of October, 1915.

Witness: J.N.Weston.

Joseph Dougherty.

H.C.Dreis.

Filed and Recorded at request of Joseph Dougherty, Oct., 4, A.D., 1915, at 4:35 O'clock P.M., Book 7 Mill-Site & Water Rights, pages 84-85; Records of Yavapai County, Arizona.

BY, - E.A.McSwiggin, Deputy Recorder.

(SEAL.) L.S.Colwell,
County Recorder.

#####

#####

#####

#####

#####

#####

#####

#####

#####

#####

#####

#####

STATE OF ARIZONA, }
 COUNTY OF YAVAPAI. } ss.

I, L. S. Colwell, County Recorder in and for the County of Yavapai, State of Arizona, and custodian of the records of such office, do hereby certify that I have compared the foregoing copies with, and that the same is a full, true and correct copies of **Six (6) Amended Mining Location Notices; and Two (2) Mill Site Location Notices;** - same being located by **Joseph Dougherty and H.C.Dreis,** -and _____ P.M. filed for record on **Oct., 4th., A.D., 1915, at 4:35-0'clock,** and as the same appears of record in my office in Book **86,** of **Mines, -Pages 521-526;** -and **BOOK 7, Mill-Sites & W.R.** at pages **84-86,** and of the whole thereof.

IN WITNESS WHEREOF, I have hereunto set my hand and affixed my Official Seal this **5th.,** day of **OCTOBER,** _____, A. D. 1915.

L. S. Colwell
 County Recorder.



4-688.

U. S. SURVEYOR-GENERAL'S FINAL CERTIFICATE ON FIELD NOTES.

Department of the Interior,

OFFICE OF U. S. SURVEYOR-GENERAL,

Phoenix, Arizona,

February 16, 1916.

I, U. S. Surveyor-General for District of Arizona

do hereby certify that the foregoing transcript of the Field Notes, return and approval of the survey of the mining claim of

JOSEPH DOUGHERTY and H. C. DREIS.

known as the NEW YORK, INDIANA, IOWA, IDAHO, OHIO, GOODLUCK lodes and INDIANA, OAK TREE MILL SITES.

situate in THUMB BUTTE

Mining District, YAVAPAI County, ARIZONA.

in Section s 14 - 15, Township No. 14 N., Range No. 3 W.,

designated as Survey No. 3246 A&B, has been correctly copied from the originals on file in this office; that said Field Notes furnish such an accurate description of said mining claim as will, if incorporated into a patent, serve fully to identify the premises, and that such reference is made therein to natural objects or permanent monuments as will perpetuate and fix the *locus* thereof.

And I further certify that five hundred dollars' worth of labor has been expended or improved or for each of improvements made upon said mining claims by claimants or their grantors, and that said improvements consist of 12 shafts, 7 cuts, 5 tunnels and 1 winze, total value \$25,320. Improvement No. 3 on the Iowa lode being a common improvement for the benefit of all the lodes in this survey excepting the Goodluck, which is at a lower elevation than the said improvement, an undivided one-fifth interest therein, value \$2514. is properly credited to each the Iowa, Ohio, Idaho, New York and Indiana lodes.

and that no portion of said labor or improvements has been included in the estimate of expenditures upon any other claim.

I further certify that the plat thereof, filed in the U. S. Land Office at Phoenix,

Arizona, is correct and in conformity with the foregoing Field Notes.

Frank P. Trott

United States Surveyor-General for Arizona

4-687.

SURVEYOR-GENERAL'S CERTIFICATE OF APPROVAL OF FIELD NOTES AND SURVEY OF MINING CLAIM.

Department of the Interior,

Office of U. S. Surveyor-General,

Phoenix, Arizona,

February 16, 1916

I, U. S. Surveyor-General for District of Arizona

do hereby certify that the foregoing and hereto attached Field Notes and Return of the Survey of the Mining Claim of

JOSEPH DOUGHERTY and H. C. DREIS.

known as the

NEW YORK INDIANA, IOWA, IDAHO, OHIO, GOODLUCK lodes and INDIANA, OAK TREE MILL SITES.

situate in THUMB BUTTE Mining District,

YAVAPAI County, ARIZONA.

in Sections 14 - 15, Township No. 14 N., Range No. 3 W.

designated as Survey No. 3246 A&B

executed by J. William Waara, U. S. Deputy Mineral

Surveyor, October 11-16, 1915, under my instructions dated

October 6, 1915, have been critically examined and the necessary cor-

rections and explanations made, and the said Field Notes and Return, and the Survey they describe,

are hereby approved. A true copy of the copy of the location certificate filed by the applicant for

survey is included in the field notes.

Frank D. Roth

U. S. Surveyor-General for Arizona.